



asma-1 Child

Guide for Healthcare Professionals

Testing Subject

- 1 Insert mouthpiece and
Ⓛ switch on

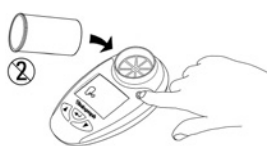

- 2 Blow 3 times

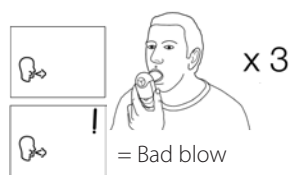

- 3 ▼ View values for parameters
FEV₅, FEV₇₅, FEV₁ and PEF



- 4 Best blow



PEF +/- 5%; FEV₁ +/- 3%

Review History

- 1 Ⓛ Switch On



- 2 ← Hold for 3 seconds



- 3 ▲ or ▼ Review History



- 4 ← Return



Delete History

- 1 Ⓛ Switch on



- 2 ▼ + ← Hold for 10 seconds



Cleaning and Disinfecting:

The outer surfaces should be cleaned every week, more often if necessary. The use of an ordinary alcohol wipe is recommended, with special attention to the mouthpiece area.

EN ISO 23747:2009

Specifies accuracy: ± 10% PEF
Resistance to flow: < 0.35 kPa/L/s

Vitalograph Childrens Respiratory Monitor

Accuracy: ± 5% PEF, ± 3% FEV₁, -5/-75
Resistance to flow: < 0.15kPa/L/s