



COPD Screener



Quick Start Guide

Prepare Device

- 1 ① Switch On.



- 2 Set test subject's age.

Press ▲ or ▼
to change age.

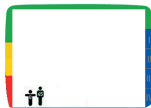

Press ← to set.

- 3 Set test subject's height.

Press ▲ or ▼
to change height.



Press ← to set.

- 4 Set test subject's gender.

Press ▲ or ▼
to change gender.



Press ← to set.

- 5 Set test subject's population group.

Press ▲ or ▼
to change
population group.



Press ← to set.

No.	Population Group	Ref
1	European (default)	ERS 1993
2	Asian	ERS 1993
3	African	ERS 1993
4	Chinese	ERS 1993
5	Japanese	ERS 1993
6	Polynesian	ERS 1993
7	Caucasian	NHANES III
8	African-American	NHANES III
9	Mexican-American	NHANES III
or		
20 and above	Weight (weight not normally required)	kg

Perform Test

- 1 Insert disposable SafeTway mouthpiece.

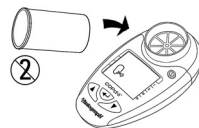

- 2 Demonstrate to test subject.

- ▼ Fully breathe in, hold ...
- ▼ Insert and lightly bite the mouthpiece
- ▼ Then blow as hard as possible for 6 s (wait for beep)
- ▼ WELL DONE! Rest test subject for a short while and wait for blow icon to reappear



- 3 Repeat blow 2 more times.

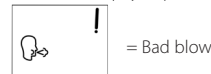

Test Result

- 1 Press ← to show result



Negative



- ▼ Spirometry not required
- ▼ COPD Classification green

Positive



- ▼ Refer for spirometry
- ▼ COPD Classification I to IV

View Parameters

- 1 Display shows FEV1 and % of predicted.

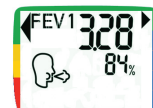

- 2 Press ▼ to show FEV6 and % of predicted.

- 3 Press ▼ to show FEV Ratio and % of predicted.

- 4 Press ▼ to show Lung Age.

